

**APPENDIX C**

---

**Oak Tree Mitigation Plan**

THE MASTER'S COLLEGE, Santa Clarita, CA  
Revised: 2008.08.20

OAK TREE MITIGATION TABULATION (LM-1 thru LM-3)

TREE TYPE (sp-size)	QTY.	% of TOTAL	UNIT PRICE	TYPE TOTAL
<b>Quercus Agrifolia</b>				
A15	115	17.75%	\$200	\$23,000
A24	162	25.00%	\$350	\$56,700
A36	54	8.33%	\$1,500	\$81,000
A48	19	2.93%	\$2,000	\$38,000
A80	9	1.39%	\$4,000	\$36,000
A72	8	1.23%	\$6,000	\$48,000
A96	3	0.46%	\$17,000	\$51,000
A120	1	0.15%	\$25,000	\$25,000
	371	57.25%		
<b>Quercus Chrysolepis</b>				
C15	47	7.25%	\$200	\$9,400
C24	61	9.41%	\$350	\$21,350
C36	8	1.23%	\$1,500	\$12,000
C48	2	0.31%	\$2,000	\$4,000
C60	1	0.15%	\$4,000	\$4,000
C72	1	0.15%	\$6,000	\$6,000
C96	0	0.00%	\$17,000	\$0
C120	0	0.00%	\$25,000	\$0
	120	18.52%		
<b>Quercus Douglasii</b>				
D15	21	3.24%	\$200	\$4,200
D24	31	4.78%	\$350	\$10,850
D36	2	0.31%	\$1,500	\$3,000
D48	0	0.00%	\$2,000	\$0
D60	0	0.00%	\$4,000	\$0
D72	0	0.00%	\$6,000	\$0
	54	8.33%		
<b>Quercus Lobata</b>				
L15	29	4.48%	\$200	\$5,800
L24	24	3.70%	\$350	\$8,400
L36	30	4.63%	\$1,500	\$45,000
L48	14	2.16%	\$2,000	\$28,000
L60	2	0.31%	\$4,000	\$8,000
L72	2	0.31%	\$6,000	\$12,000
L96	1	0.15%	\$17,000	\$17,000
L120	1	0.15%	\$25,000	\$25,000
	103	15.90%		
	648	100.00%		\$557,700

(INSTALLED OAK UNIT PRICE LIST SUPPLIED BY CITY OF SANTA CLARITA ARBORIST - CONTACT: WAYNE SMITH PH: 661.259.2489)

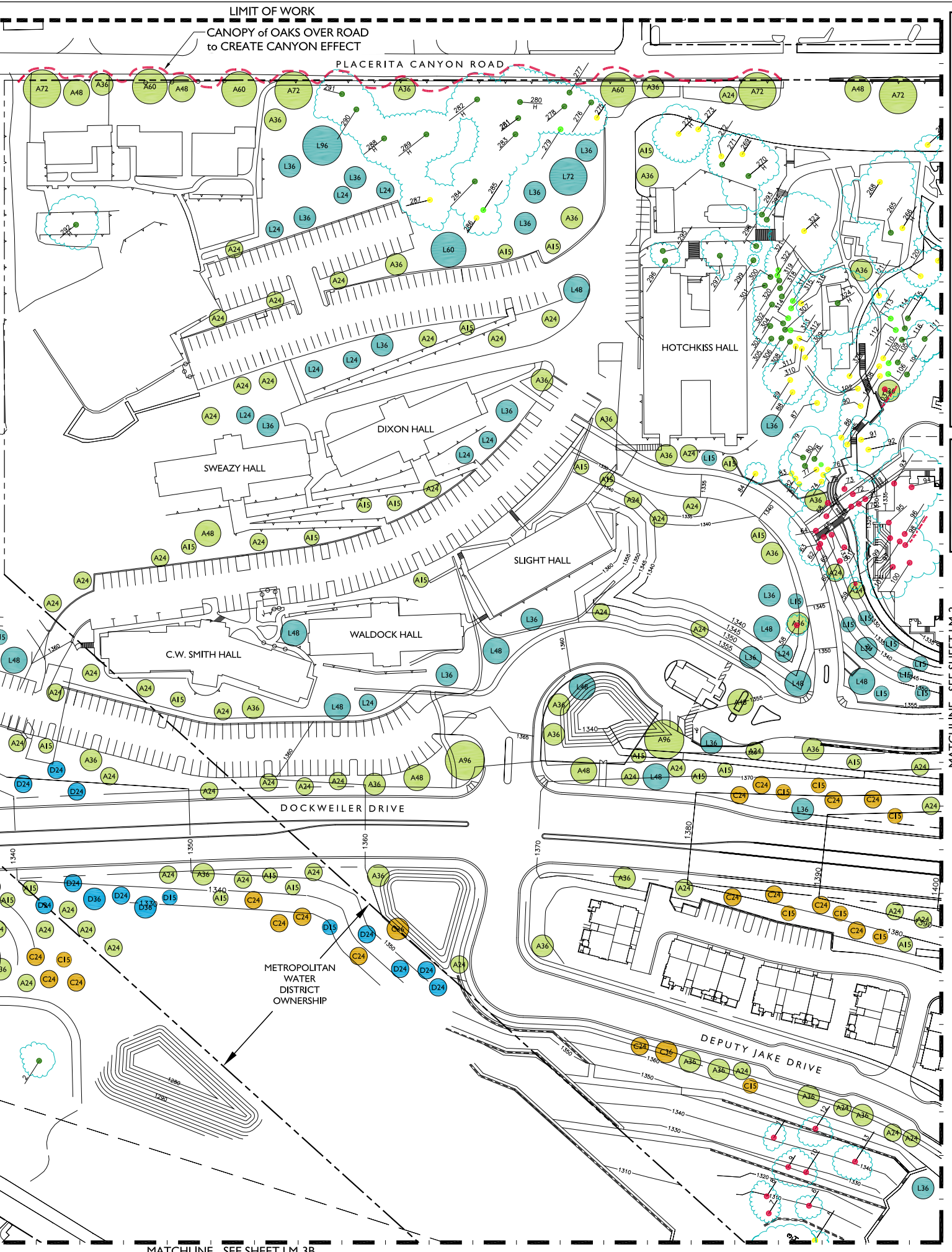

PROPOSED OAK LEGEND: QTY.(all sheets) % of TOTAL

A24	QUERCUS AGRIFOLIA	371	57%
C24	QUERCUS CHRYSOLEPIS <sup>1</sup>	120	19%
D24	QUERCUS DOUGLASII <sup>2</sup>	54	8%
L24	QUERCUS LOBATA	103	16%
TOTAL:		648	100%

KEY:

OAK SPECIES

CONTAINER SIZE

SIZE BREAKDOWN: QTY.(all sheets) % of TOTAL

15 GALLON	212	33%	
24" BOX	278	43%	
36" BOX	94	14%	
48" BOX	35	5%	
60" BOX	12	2%	
72" BOX	11	2%	
96" BOX & LARGER	6	1%	
TOTAL:		648	100%

FOOTNOTES:

1. CONTAINER SIZES OF CANYON OAK GREATER THAN 48" BOX IS LIMITED. CANYON OAK WILL BE SUBSTITUTED WITH COAST LIVE OAK IF AVAILABILITY IS NOT SUFFICIENT AT THE TIME OF INSTALLATION.

2. CONTAINER STOCK OF BLUE OAKS IS LIMITED. BLUE OAKS WILL BE SUBSTITUTED WITH COAST LIVE OAK IF AVAILABILITY IS NOT SUFFICIENT AT THE TIME OF INSTALLATION.

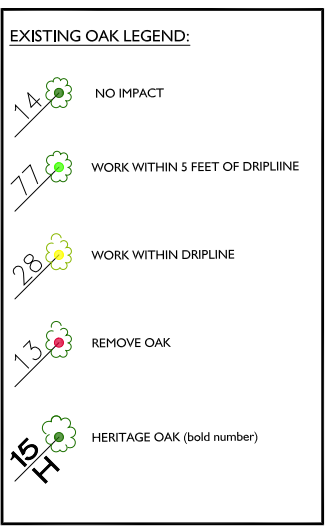

FOR PROPOSED OAK MITIGATION PLANTING CONCEPT SEE SHEET LM-3.

STREET TREE NOTE:  
DOCKWEILER DRIVE and DEPUTY JAKE DRIVE STREET TREES AS DETERMINED BY CITY OF SANTA CLARITA PUBLIC WORKS DEPARTMENT ARE NOT SHOWN ON THIS PLAN

MJSDesign Group Inc.  
Landscape Architecture  
Planning  
Design

511 30th St.  
Newport Beach, CA 92663  
(949) 675-9964  
Fax (949) 675-9974  
mjsdesigngroup.com

Client: THE MASTER'S COLLEGE  
21726 PLACERITA CANYON ROAD  
SANTA CLARITA, CALIFORNIA 91321

Project: OAK TREE MITIGATION PLAN



Issued For:

2007.04.13 CLIENT REVIEW  
2008.06.13 CLIENT REVISIONS  
2008.08.20 CLIENT REVISIONS

Revisions:  
12-10-2007 ADDENDUM 10-03-2007

Job No.:  
Drawn By: HC  
Check By: MS  
Plan Date: 2008.08.20  
Scale: 1" = 50'

Title: OAK TREE MITIGATION PLAN

Sheet No.: LM-1

Plan Status: CLIENT REVIEW

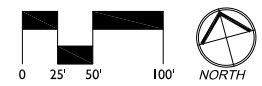

THE MASTER'S COLLEGE - LANDSCAPE ARCHITECTURE / OAK TREE MITIGATION - PHASE I



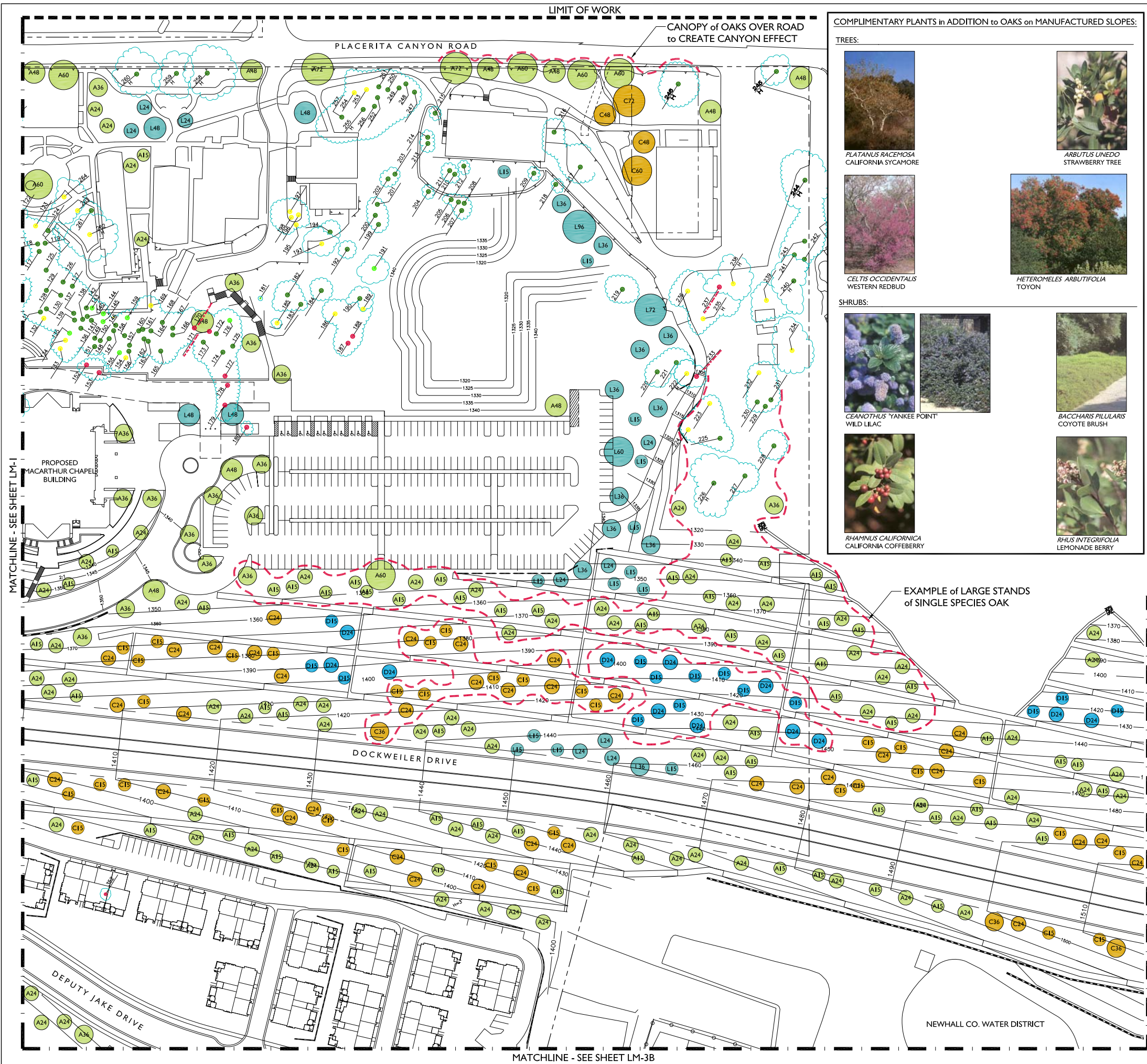

COMPLIMENTARY PLANTS in ADDITION to OAKS on MANUFACTURED SLOPES:

TREES:

- PLATANUS RACEMOSA* CALIFORNIA SYCAMORE
- ARBUTUS UNEDO* STRAWBERRY TREE
- CELTIS OCCIDENTALIS* WESTERN REDBUD
- HETEROMELES ARBUTIFOLIA* TOYON

SHRUBS:

- CEANOTHUS 'YANKEE POINT'* WILD LILAC
- BACCHARIS PILULARIS* COYOTE BRUSH
- RHAMNUS CALIFORNICA* CALIFORNIA COFFEBERRY
- RHUS INTEGRIFOLIA* LEMONADE BERRY

PROPOSED OAK LEGEND: QTY.(all sheets) % of TOTAL

Code	Species	QTY.(all sheets)	% of TOTAL
A24	QUERCUS AGRIFOLIA COAST LIVE OAK	371	57%
C24	QUERCUS CHRYSOLEPIS <sup>1</sup> CANYON OAK	120	19%
D24	QUERCUS DOUGLASII <sup>2</sup> BLUE OAK	54	8%
L24	QUERCUS LOBATA VALLEY OAK	103	16%
TOTAL:		648	100%

KEY: OAK SPECIES — CONTAINER SIZE

SIZE BREAKDOWN: QTY.(all sheets) % of TOTAL

Container Size	QTY.(all sheets)	% of TOTAL	
15 GALLON	212	33%	
24" BOX	278	43%	
36" BOX	94	14%	
48" BOX	35	5%	
60" BOX	12	2%	
72" BOX	11	2%	
96" BOX & LARGER	6	1%	
TOTAL:		648	100%

FOOTNOTES:

- CONTAINER SIZES of CANYON OAK GREATER THAN 48" BOX is LIMITED. CANYON OAK WILL BE SUBSTITUTED with COAST LIVE OAK if AVAILABILITY is NOT SUFFICIENT at THE TIME of INSTALLATION.
- CONTAINER STOCK of BLUE OAKS is LIMITED. BLUE OAKS WILL BE SUBSTITUTED with COAST LIVE OAK if AVAILABILITY is NOT SUFFICIENT at THE TIME of INSTALLATION.

EXISTING OAK LEGEND:

- NO IMPACT
- WORK WITHIN 5 FEET OF DRIPLINE
- WORK WITHIN DRIPLINE
- REMOVE OAK
- HERITAGE OAK (bold number)

FOR PROPOSED OAK MITIGATION PLANTING CONCEPT SEE SHEET LM-3.

STREET TREE NOTE:  
DOCKWEILER DRIVE and DEPUTY JAKE DRIVE STREET TREES as DETERMINED by CITY of SANTA CLARITA PUBLIC WORKS DEPARTMENT ARE NOT SHOWN on THIS PLAN

MJSDesign Group Inc.  
Landscape Architecture  
Planning  
Design  
Cannery Village  
511 30th St.  
Newport Beach, CA 92663  
(949) 675-9964  
Fax (949) 675-9974  
mjsdesigngroup.com

Client  
**THE MASTERS COLLEGE**  
21726 PLACERITA CANYON ROAD  
SANTA CLARITA, CALIFORNIA 91321

Project  
**OAK TREE MITIGATION PLAN**



Issued For:

2007.04.13	CLIENT REVIEW
2008.06.13	CLIENT REVISIONS
2008.08.20	CLIENT REVISIONS

Revisions:

12-10-2007	ADDENDUM 10-03-2007
------------	---------------------

Job No.:  
Drawn By: HC  
Check By: MS  
Plan Date: 2008.08.20  
Scale: 1" = 50'

Title:  
**OAK TREE MITIGATION PLAN**

Sheet No.:  
**LM-2**  
Plan Status:  
**CLIENT REVIEW**

